

NOTICE OF INTENT (NOI) TO HARVEST TIMBER

A Timber Harvesting Plan (THP) or Amendment has been submitted to the California Department of Forestry and Fire Protection (CAL FIRE). CAL FIRE Forest Practice will be reviewing the proposed timber operation for compliance with State law and rules of the California Board of Forestry and Fire Protection. The following briefly describes the proposed timber operation and where and how to get more information. Prior to submission of the THP or Amendment, this Notice, including a map as described in 14 CCR § 1032.7(d)(8) shall be posted at a conspicuous location on the public road nearest the Plan, be on colored paper or identified with colored flagging per 14 CCR § 1032.7(h) and adhere to any special county rules.

This Notice applies to (select one): New Timber Harvesting Plan Amendment for an approved THP
THP#: _____

NOTE: incorrect, incomplete, or inconsistent information within the THP or Amendment and this Notice may result in a Plan return to the Plan Submitter

Applicant Information: The names of the Timberland Owner(s), Registered Professional Forester who prepared the Plan and Plan Submitter must match those listed in the THP or Amendment.

1. Timberland Owner(s): Sierra Pacific Land & Timber Co.
2. Plan Submitter(s): Sierra Pacific Industries
3. Registered Professional Forester: Joseph Starr
Registered Professional Forester Phone (optional): _____
4. The name of the THP: Scooter THP

FILED

MAY 21 2026

#19

SEAN HOUGHTBY

TEHAMA COUNTY CLERK & RECORDER

BY Ariana Repede

Project Summary: Acres proposed for harvest, county, legal description, silviculture, treatments, special or alternative prescriptions, and regeneration methods must match those listed in the THP or Amendment.

5. Acres proposed for harvest: 824
6. County: Butte & Tehama
7. Legal Description of the Public Land Survey System (Section, Township, Range, Baseline and Meridian)

MDM T26N R03E S12, 13, & 25; MDM T26N R04E S4, 5, 7, 8, 9, 10, 14, 15, 16, 17, 18,19, 20, 21, 22, 29, & 30

8. Location of the proposed timber operation with approximate direction and approximate distance of the timber operation from the nearest community or well-known landmark:

Adjacent to and up to 4 miles North of Butte Meadows. West of Colby Mtn. and East of Highway 32.

9. The name of, and distance from, the nearest perennial stream and major watercourse flowing through or downstream from the timber operation:

Butte Creek flows along the southern boundary of the general plan area. Chico Creek and Cascade Creek flow through the immediate plan area with harvest boundaries directly adjacent to both.

10. List the Silvicultural Systems to be used, including Regeneration Methods, Intermediate Treatments, Special Prescriptions, and Alternative Prescriptions:

Unevenaged Mgt. (Selection), Special Prescription (Fuelbreak/Defensible Space), Evenaged Mgt. (Clearcut), Non-Regeneration (Road-Right-of-Way)

11. Are there overhead electrical power lines within the Plan area (Except lines from transformers to service panels) or overhead powerlines within 200 feet outside the Plan boundary? Yes No

12. Santa Cruz County only: Have approximate property lines been flagged for review where truck roads, tractor roads or harvest areas are within 100 feet of the property line? [ref. 14 CCR § 926.3(a)(1)]
 Yes No

Additional Information: Provide the names and mailing addresses of all property owners within three-hundred (300) feet of the THP or Amendment boundary. [ref. 14 CCR § 1032.7(e)]

Provide the names and mailing addresses of the utilities that operate overhead electrical power lines within the THP or Amendment boundary or within two-hundred (200) feet outside the Plan boundary. [ref. 14 CCR § 1032.7(f)]

Provide a map with the approximate boundary of the THP area, a map legend, and a scale. The map shall be posted with this Notice. [ref. 14 CCR § 1032.7(d)(8)]

Public Information: In accordance with the timeline stated under Public Resources Code Section 4582.7, written public comments may be submitted for the THP or Amendment for CAL FIRE to consider.

The review times allowed for CAL FIRE to review the proposed timber operation are variable. To ensure CAL FIRE receives submitted comments please read the following:

The estimated earliest possible date CAL FIRE may approve this THP or Amendment is: 6/1/2026

(This estimated date is 15 calendar days from receipt of the THP or Amendment by CAL FIRE, except in counties for which special rules have been adopted where the earliest date is 45 calendar days after receipt.)

NOTE: The estimated earliest approval date is probably not the actual approval date. Often, there is more time available for public comment submittals. Please check with CAL FIRE Forest Practice to determine the actual date that the public comment period closes.

Anyone may review or purchase a copy of the THP or Amendment from the CAL FIRE Review Team office shown below. The copying cost is **37 cents** for each page, \$2.50 minimum per request.

Questions, concerns, and public comments regarding this THP, Amendment, or Notice should be directed to the CAL FIRE Review Team office shown below which may be incorporated into an Official Response Document.

Please include the Timber Harvesting Plan number on all correspondence.

Direct comments to the *CAL FIRE Forest Practice Program Manager* of the marked submitted office below:

Santa Rosa (Coast District) Redding (Northern District) Fresno (Southern District)

135 Ridgway Avenue Santa Rosa, CA 95401 (707) 576-2959 SantaRosaPublicComment@fire.ca.gov	6105 Airport Road Redding, CA 96002 (530) 224-2454 ReddingPublicComment@fire.ca.gov	1234 East Shaw Avenue Fresno, CA 93710 (559) 222-3714 FresnoPublicComment@fire.ca.gov
--	--	--

NOTE: To view the contents of this THP or Amendment or submit public comments online go to the CAL FIRE Forest Practice website "CalTREES" at <https://caltreesplans.resources.ca.gov/caltrees/>

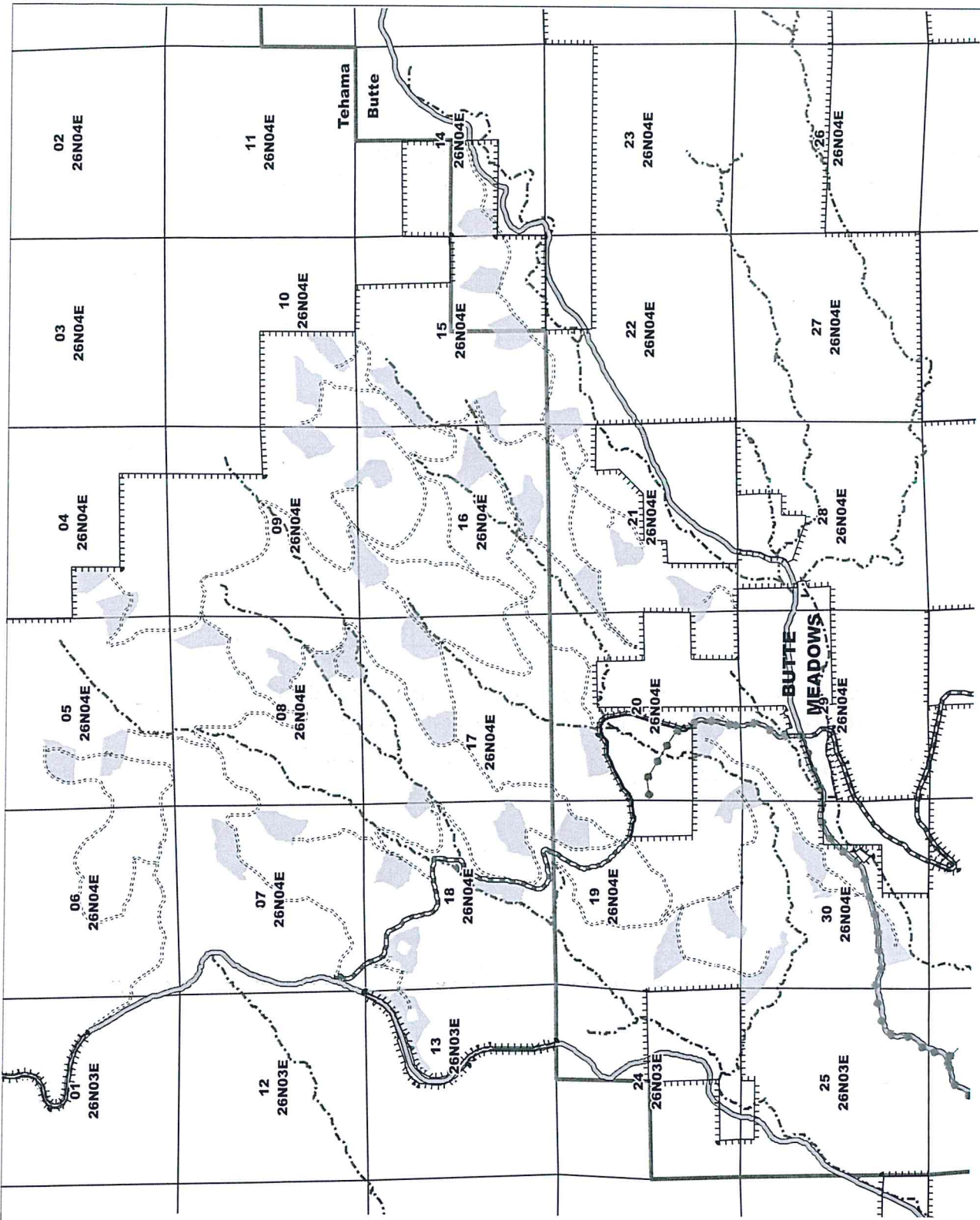

Scooter THP
Vicinity Map

This map is a copyrighted document; it may not be copied, republished or used in any other work without the express written permission of Sierra Pacific Industries (the copyright holder).

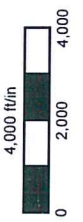

Utility Contact for Powerline Adjacent to Operations:

Pacific Gas & Electric Company
 Attn: John Breazeal RPF
 12626 Jackson Gate Road
 Jackson, CA 95642
 (209) 419-1705
john.breazeal@pge.com

Contact List of Neighboring Landowners Within 300 feet of Operations; Source of Information is Parcel Quest.

Name	Address	APN	Note
Lassen National Forest Almanor Ranger District	PO Box 767 Chester, CA 96020	multiple	Within 300 feet of Operations
Boys Scouts of America	3852 N. Freeway Blvd. Ste. 100 Sacramento, CA 95834 or PO Box 13558 Sacramento, CA 95853	Butte 060-060-013-000	Within 300 feet of Operations
Cal Trans Survey Office	1031 Butte St. MS 37 Redding, CA 96001 or 703 B St. Marysville, CA 95901	unknown	Within 300 feet of Operations
Christine Zebley	2715 Pillsbury Rd. Chico, CA 95973	060-060-008-000	Within 300 feet of Operations
Carpenter Revocable Trust	PO Box 3908 Paradise, CA 95967	060-230-032-000	Within 300 feet of Operations
Garth & Susan Laughridge	1627 Nord Ave. Chico, CA 95926	060-240-001-000	Within 300 feet of Operations
Woodmansee Family Trust	1018 Plum Ln. Davis, CA 95616	060-230-031-000	Within 400 feet of Operations
Linda Carlson	PO Box 104 Forest Ranch, CA 95942	060-230-033-000	Within 400 feet of Operations