

FILED

#23

MAY 13 2024



JENNIFER A. VISE
TEHAMA COUNTY CLERK & RECORDER

BY Chasman

NOTICE OF EXEMPTION

To:	County Clerk Tehama County, CA 633 Washington St., Room 111 Red Bluff, CA 96080	FROM:	RCD of Tehama County P.O Box 1232 Red Bluff, CA 96080
------------	--	--------------	---

PROJECT TITLE	Manton Phase II: Fuels Reduction and Community Safety
----------------------	---

PROJECT LOCATION	Powerhouse Road & Hazen Road Shaded Fuel Break – Manton (40.41712,-121.87161)	COUNTY	Tehama
-------------------------	---	---------------	--------

DESCRIPTION OF NATURE, PURPOSE, AND BENEFICIARIES OF PROJECT

Project 1: Powerhouse Road Shaded Fuel Break

Description: This project will complement and build upon work completed last year as well as a preexisting PG&E shaded fuel break. The aspiration of the project is to enhance the community of Manton's safety and wildfire resilience by mitigating the threat of high severity wildfire.

- The project is located within a Tier 2 CPUC Fire Threat Area. Classified as Very High Wildfire Severity zone by CAL FIRE.
- The entire project area is within 100ft of PG&E distribution/transmission lines that run parallel to Powerhouse Road.
- The project will cover up to 8.3 treated acres. A 50ft Fuel Break on the West side of Powerhouse Road for 1.2 miles with 20ft of additional Fuel Break on the East side of road for .5 miles. Note, a 20ft fuel break was completed in 2023 for 1.1 miles of the road.

Prescription: work will be completed utilizing a combination of mastication and hand crew. Mastication will be utilized in large areas with heavy shrubbery (predominantly Manzanita, Live Oak, and Coyote Brush in this area). Hand crew will be utilized for intricate areas around property fence lines or areas of aesthetic or environmental constraints. All brushes and trees under 10" DBH will be removed. Woody debris and brush will be removed, masticated, and/or chipped. Trees greater than 10" DBH will be limbed 8-10ft from the ground. Annual grass will be weed whacked. Follow up herbicide will be applied as maintenance to guarantee perpetuity of work (budget permitting).

Administration: staff will project manage, create schedules, obtain County Encroachment Permit, File CEQA NOE, and coordinate outreach with local Manton Firesafe Council.

Note: Manton community is only 800ft from 2011 Ponderosa Fire and suffered a local fire in 2020

Project 2: Hazen Rd. Shaded Fuel Break

Description: The Hazen Road Shaded Fuel Break will assist in providing safer ingress and egress for community members, emergency personnel, and PG&E staff. Additionally, it will create extensions of previously completed fuel breaks that will mitigate the potential spread of future high intensity wildfire to this local WUI community.

PG&E Fuel Reduction and Fire Safety Project 2024

- The project is located within a Tier 2 CPUC Fire Threat Area. Classified as Very High Wildfire Severity zone by CAL FIRE.
 - The entire project area is within 100ft of PG&E distribution/transmission lines that run parallel to Powerhouse Road.
 - This will equate to 500,000 sq. ft. or 11.5 acres of treated area. The total Project 2 area will be 22.4 acres, over 940,000 sq. ft.
 - The project will consist of 2 sections.
1. Section 1 will extend around Hazen Road. North of Hazen Road will extend for 2000ft and be a 20ft shaded fuel break parallel to the road.

2. The south portion of the Fuel break will extend 100ft in total for 4,000ft. This section will total 440,000 sq. ft. or 10.91 Acres. Section 2: will start at Cross County Canal and extend 25ft on either side of the PG&E distribution line for 5,000ft.

Prescription: work will be completed utilizing a combination of mastication and hand crew. Mastication will be utilized in large areas with heavy shrubbery (predominantly Manzanita, Live Oak, and Coyote Brush in this area). Hand crew will be utilized for intricate areas around property fence lines or areas of aesthetic or environmental constraints. All brushes and trees under 10" DBH will be removed. Woody debris and brush will be removed, masticated, and/or chipped. Trees greater than 10" DBH will be limbed 8-10ft from the ground. Annual grass will be weed whacked. Follow up herbicide will be applied as maintenance to guarantee perpetuity of work (budget permitting).

LEAD AGENCY RCD of Tehama County

CONTACT PERSON Drew Barnhart **PHONE** (916) 525 5510

ADDRESS P.O Box 1232
Red Bluff, CA 96080

NAME OF PUBLIC AGENCY APPROVING PROJECT: Resource Conservation District of Tehama County

NAME OF PERSON OR AGENCY CARRYING OUT PROJECT: Tehama Conservation Fund

EXEMPTION STATUS

- Categorical Exemption Type/Section: Class 4 §15304 (e) Minor Alterations to Land
 Statutory Exemption (state code section):
 Ministerial (§21080(b)(1); 15268)
 Declared Emergency (§21080(b)(3); 15269(a))
 Emergency Project (§21080(b)(4); 15269(b)(c))

REASONS PROJECT IS EXEMPT

Public Resources Code, Division 13, Chapter 6, Article 19, Section 15304 allows minor alteration of vegetation including fuel management activities to reduce volume of flammable vegetation provided the activities do not result in the taking of endangered, rare, or threatened plant/animal species, or cause significant erosion and sedimentation of surface waters. This project is considered low impact given that the nature of the project work occurs on already disturbed and developed roadsides and biomass chips will be broadcast onsite. A current California Natural Diversity Database search was conducted, and it has been determined that Project activities will have a low impact on the environment and low potential to effect cultural resources.

IF FILED BY APPLICANT:

1. Attached certified document of exemption finding.
2. Has a Notice of Exemption been filed by the public agency approving the project? x yes

SIGNATURE:  **DATE:** 5/13/24

TITLE: RCD of Tehama County Project Manager, Drew Barnhart

- Signed by Lead Agency
 Signed by Applicant

Date received for filing at OPR:

Manton Phase II: Fuels Reduction and Community Safety

Intro, Scope of Work & Timeline

Introduction

In collaboration with the Manton Firesafe Council and CAL FIRE's Tehama-Glenn Unit, the Resource Conservation District of Tehama County (RCDTC) identified 3 project areas for shaded fuel breaks along roads that are a major ingress/egress route for the Wildland Urban Interface (WUI) community of Manton. These project roadways are heavily overgrown with decreased sight distance, and in some areas with canopies touching from the east side vegetation to the west side vegetation. In the event of another wildfire in this area, the amount of fuel along these routes would make escape difficult, if not impossible, and could cause bodily harm and/or death. PG&E infrastructure could also be negatively impacted by wildfire as the volume of fuel load within the community would affect the power grid and hinder communications and lifesaving activities. In such an event, emergency personnel, including firefighters and equipment, could also have difficulties accessing Manton due to the overgrowth. The identified project areas would build upon 2023 PG&E project work (Manton School Road and Powerhouse Road Projects) in the area with the overall mitigation of wildfire threat in a High Fire Threat District.

Project 1: Powerhouse Road Shaded Fuel Break

Description: This project will complement and build upon work completed last year as well as a preexisting PG&E shaded fuel break. The aspiration of the project is to enhance the community of Manton's safety and wildfire resilience by mitigating the threat of high severity wildfire.

- The project is located within a Tier 2 CPUC Fire Threat Area. Classified as Very High Wildfire Severity zone by CAL FIRE.
- The entire project area is within 100ft of PG&E distribution/transmission lines that run parallel to Powerhouse Road.
- The project will cover up to 8.3 treated acres. A 50ft Fuel Break on the West side of Powerhouse Road for 1.2 miles with 20ft of additional Fuel Break on the East side of road for .5 miles. Note, a 20ft fuel break was completed in 2023 for 1.1 miles of the road.

Prescription: work will be completed utilizing a combination of mastication and hand crew. Mastication will be utilized in large areas with heavy shrubbery (predominantly Manzanita, Live Oak, and Coyote Brush in this area). Hand crew will be utilized for intricate areas around property fence lines or areas of aesthetic or environmental constraints. All brushes and trees under 10" DBH will be removed. Woody debris and brush will be removed, masticated, and/or chipped. Trees greater than 10" DBH will be limbed 8-10ft from the ground. Annual grass will be weed whacked. Follow up herbicide will be applied as maintenance to guarantee perpetuity of work (budget permitting).

Administration: staff will project manage, create schedules, obtain County Encroachment Permit, File CEQA NOE, and coordinate outreach with local Manton Firesafe Council.

Note: Manton community is only 800ft from 2011 Ponderosa Fire and suffered a local fire in 2020

Project 2: Hazen Rd. Shaded Fuel Break

Description: The Hazen Road Shaded Fuel Break will assist in providing safer ingress and egress for community members, emergency personnel, and PG&E staff. Additionally, it will create extensions of previously completed fuel breaks that will mitigate the potential spread of future high intensity wildfire to this local WUI community.

- The project is located within a Tier 2 CPUC Fire Threat Area. Classified as Very High Wildfire Severity zone by CAL FIRE.
- The entire project area is within 100ft of PG&E distribution/transmission lines that run parallel to Powerhouse Road.
- This will equate to 500,000 sq. ft. or 11.5 acres of treated area. The total Project 2 area will be 22.4 acres, over 940,000 sq. ft.
- The project will consist of 2 sections.
 1. Section 1 will extend around Hazen Road. North of Hazen Road will extend for 2000ft and be a 20ft shaded fuel break parallel to the road.
 2. The south portion of the Fuel break will extend 100ft in total for 4,000ft. This section will total 440,000 sq. ft. or 10.91 Acres. Section 2: will start at Cross County Canal and extend 25ft on either side of the PG&E distribution line for 5,000ft.

Prescription: work will be completed utilizing a combination of mastication and hand crew. Mastication will be utilized in large areas with heavy shrubbery (predominantly Manzanita, Live Oak, and Coyote Brush in this area). Hand crew will be utilized for intricate areas around property fence lines or areas of aesthetic or environmental constraints. All brushes and trees under 10" DBH will be removed. Woody debris and brush will be removed, masticated, and/or chipped. Trees greater than 10" DBH will be limbed 8-10ft from the ground. Annual grass will be weed whacked. Follow up herbicide will be applied as maintenance to guarantee perpetuity of work (budget permitting).

Administration: staff will project manage, create schedules, obtain County Encroachment Permit, File CEQA NOE, and coordinate outreach with local Manton Firesafe Council.

Project 3: Rock Creek Rd. Shaded Fuel Break

Description: The Rock Creek Rd. Shaded Fuel Break focuses on Rock Bottom Road that is parallel to PG&E lines and is a major ingress/egress road for Manton residents. This is the final component in a 3-part project that will contribute to lower wildfire risk to the remote WUI community of Manton. The project will contribute to enhanced safety, protection of PG&E infrastructure, and environmental resource conservation.

- The project will occur in Shasta County in North Manton.
- The entirety of this project area is in Tier 3 Extreme Fire Threat area.
- It will include 20ft shaded fuel break on the North and South sides of Rock Creek Road. This 40ft shaded fuel break will extend 10,000ft (1.75 miles) for 400,000 sq ft of treatment, or 9.1 acres.
- This project will progress the work previously funded by PG&E in 2023 to enhance the Manton community's safety and wildfire resilience.

Prescription: work will be completed utilizing a combination of mastication and hand crew. Mastication will be utilized in large areas with heavy shrubbery (predominantly Manzanita, Live Oak, and Coyote Brush in this area). Hand crew will be utilized for intricate areas around property fence lines or areas of aesthetic or environmental constraints. All brushes and trees under 10" DBH will be removed. Woody debris and brush will be removed, masticated, and/or chipped. Trees greater than 10" DBH will be limbed 8-10ft from the ground. Annual grass will be weed whacked. Follow up herbicide will be applied as maintenance to guarantee perpetuity of work (budget permitting).

Administration: staff will project manage, create schedules, obtain County Encroachment Permit, File CEQA NOE, and coordinate outreach with local Manton Firesafe Council.

2024 PGE Fuels Reduction Project Locations

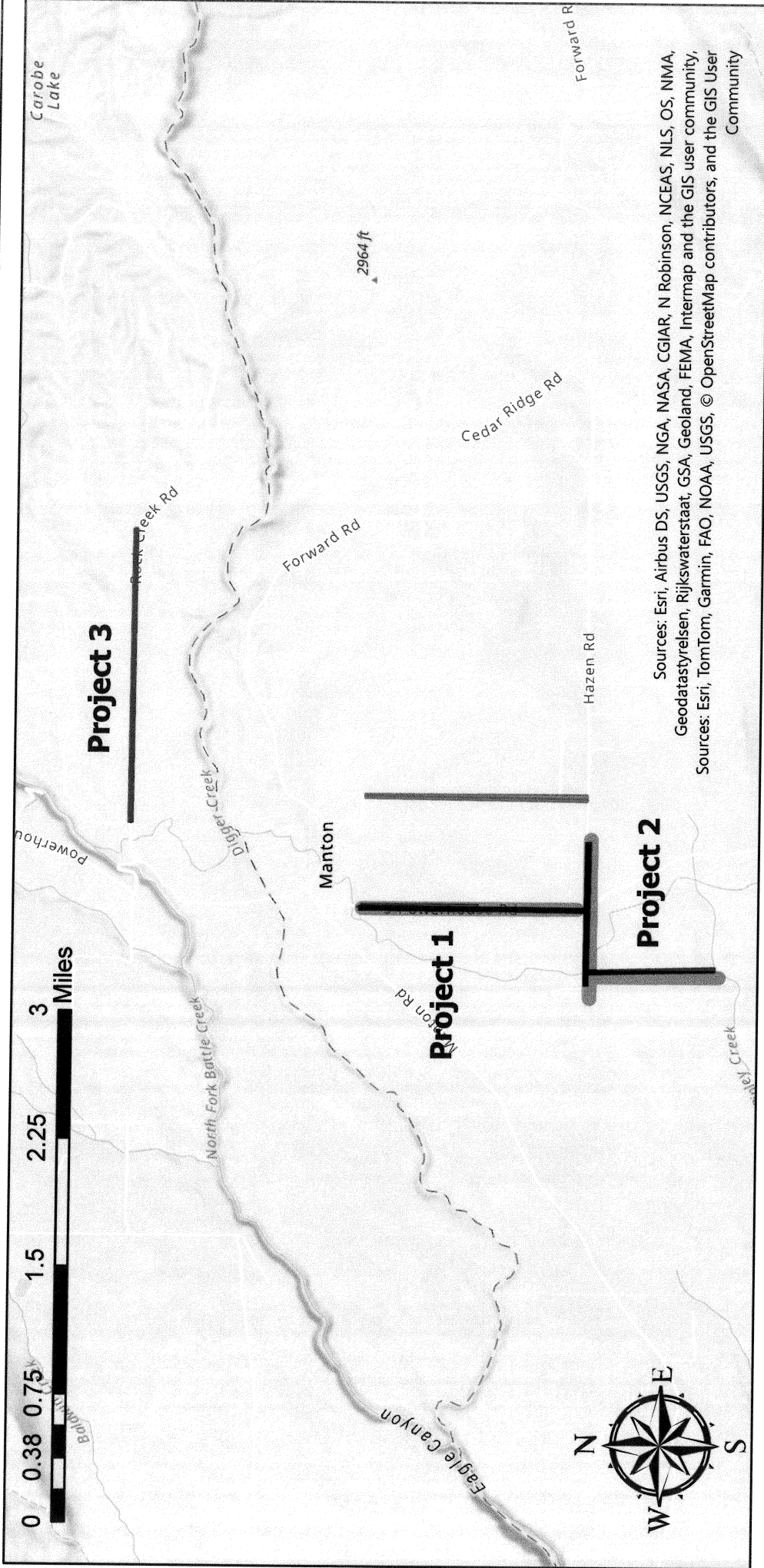

Sources: Esri, Airbus DS, USGS, NGA, NASA, CGIAR, N Robinson, NCEAS, NLS, OS, MMA, Geodatastyrelsen, Rijkswaterstaat, GSA, Geoland, FEMA, Intermap and the GIS user community,
Sources: Esri, TomTom, Garmin, FAO, NOAA, USGS, © OpenStreetMap contributors, and the GIS User Community

3 separate project locations spread across Shasta and Tehama Counties in proximity to 2 recent fire footprints. Projects 1-3 located within CPUC Tier 3 (Extreme) and Tier 2 (Elevated) Fire Threat Areas. Projects 1-3 are all within 100ft of PGE lines and are major ingress/egress locations for community and emergency personnel. Fuel breaks from Projects 1-3 will protect community, property, PGE infrastructure, and environmental resources. Total treatment will be over 3.4 miles of fuel break and 41 acres.

Project 1: Powerhouse Road Shaded Fuel Break

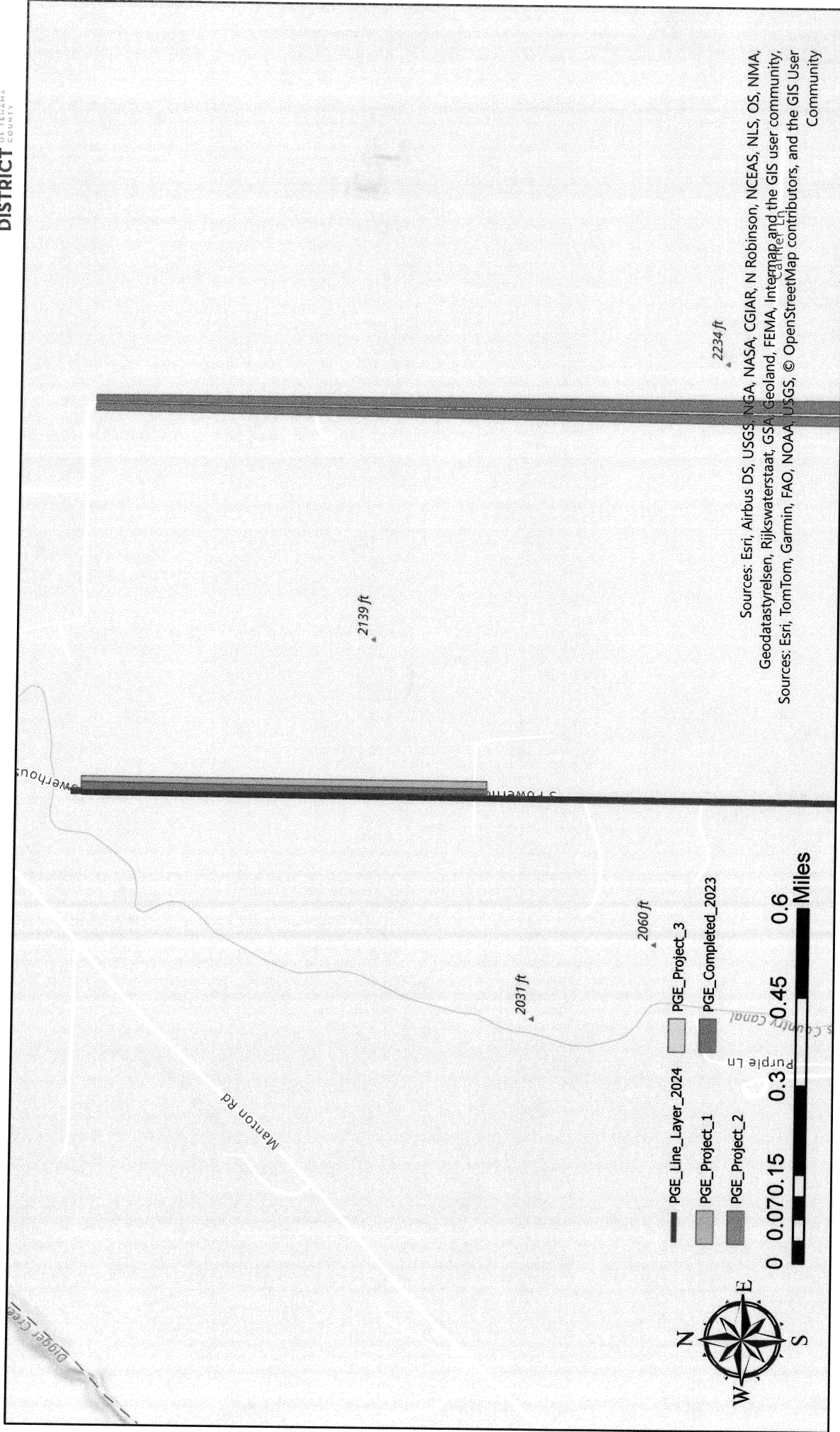

Sources: Esri, Airbus DS, USGS, NGA, NASA, CGIAR, N Robinson, NCEAS, NLS, OS, NMA, Geodatastyrelsen, Rijkswaterstaat, GSA, Geoland, FEMA, Intermap, and the GIS user community.
 Sources: Esri, TomTom, Garmin, FAO, NOAA, USGS, © OpenStreetMap contributors, and the GIS User Community

Shaded Fuel Break accounting for up to 8.3 acres of treatment. 50ft Fuel Break West side of road for 1.2 Miles. 20ft of additional Fuel Break on East Side of Road for .5 miles (20ft was completed in 2023 for 1.1 miles of Road.

Project 2: Hazen Rd. Shaded Fuel Break

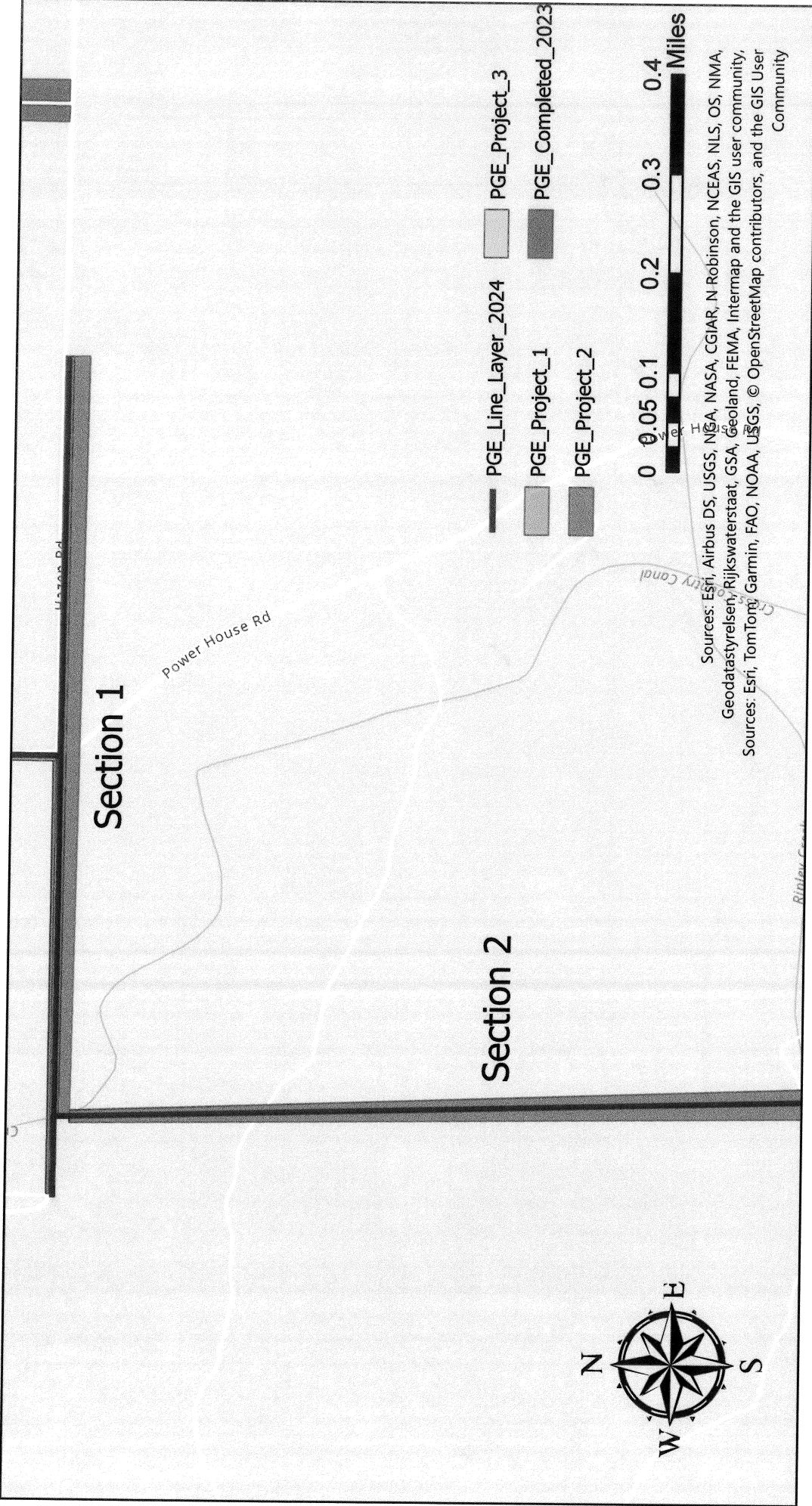

Project 2: Hazen Road Shaded Fuel Break will consist of 2 sections. Section 1 will extend around Hazen Road. North of Hazen Road will extend for 2000ft and be a 20ft shaded fuel break parallel to the road. The south portion of the Fuel break will extend 100ft in total for 4,000ft. This section will total 440,000 sq. ft. or 10.91 Acres. Section 2: will start at Cross County Canal and extend 25ft on either side of the PGE distribution line for 5,000ft. This will equate to 500,000 sq. ft. or 11.5 acres of treated area. The total Project 2 area will be 22.4 acres, over 940,000 sq. ft.

Prospective Project Area with relation to HFTD (CPUC standards – source: <https://www.cpuc.ca.gov/industries-and-topics/wildfires/fire-threat-maps-and-fire-safety-rulemaking>). Entirety of Project area occurs in Tier 2 or Tier 3 Fire Threat area.

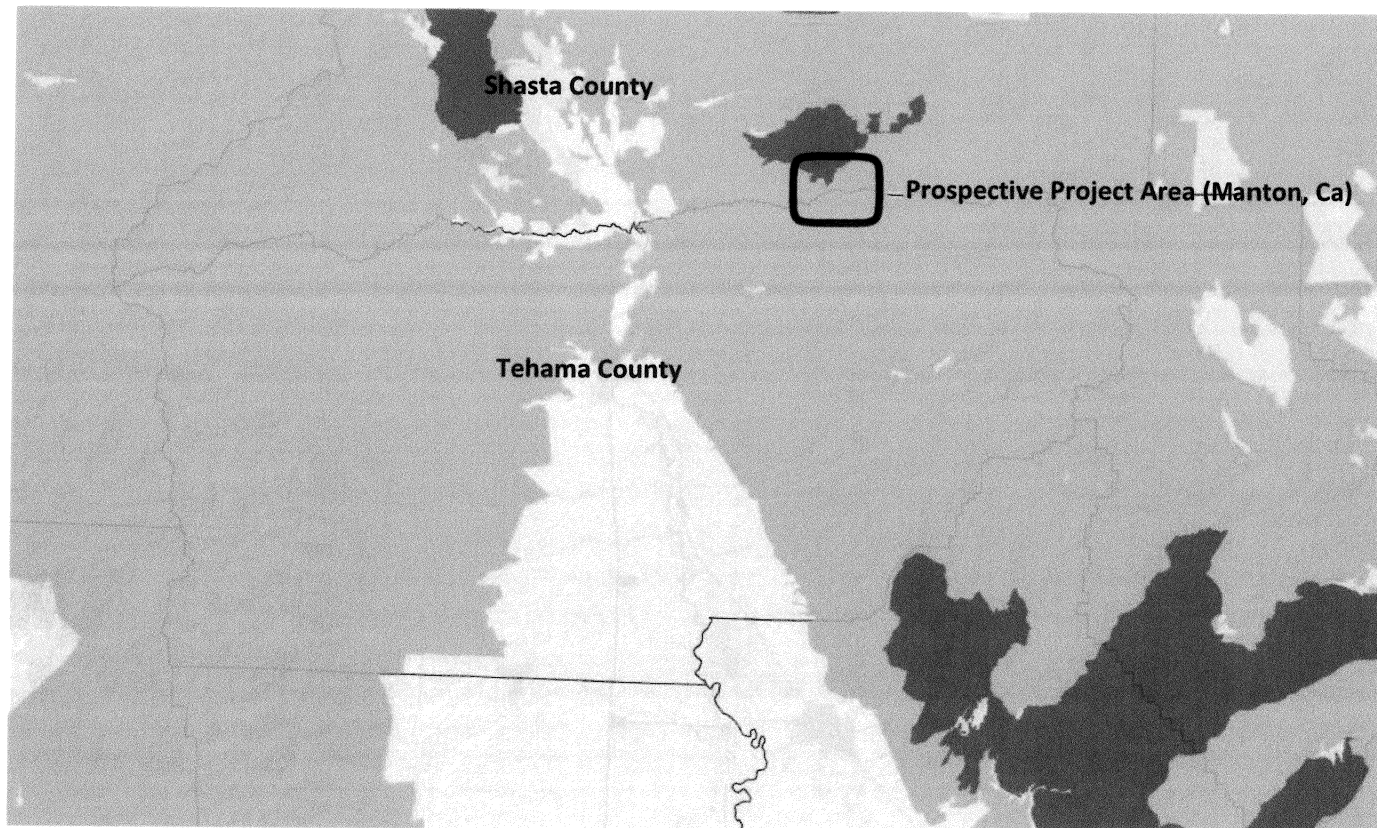
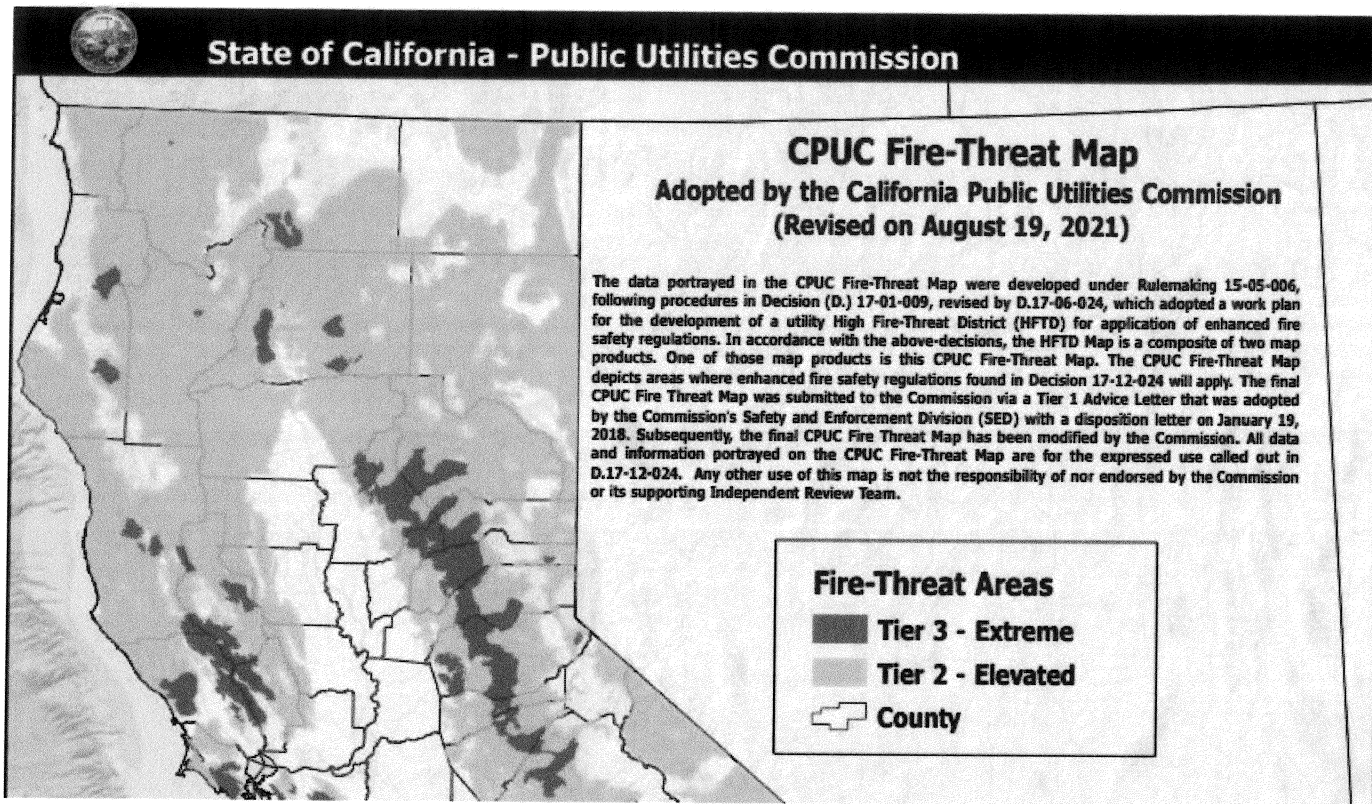

Manton 2023 PGE Project Area

Manton Roadside Fuel Project

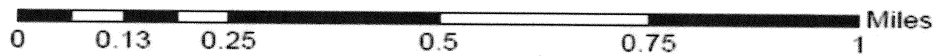
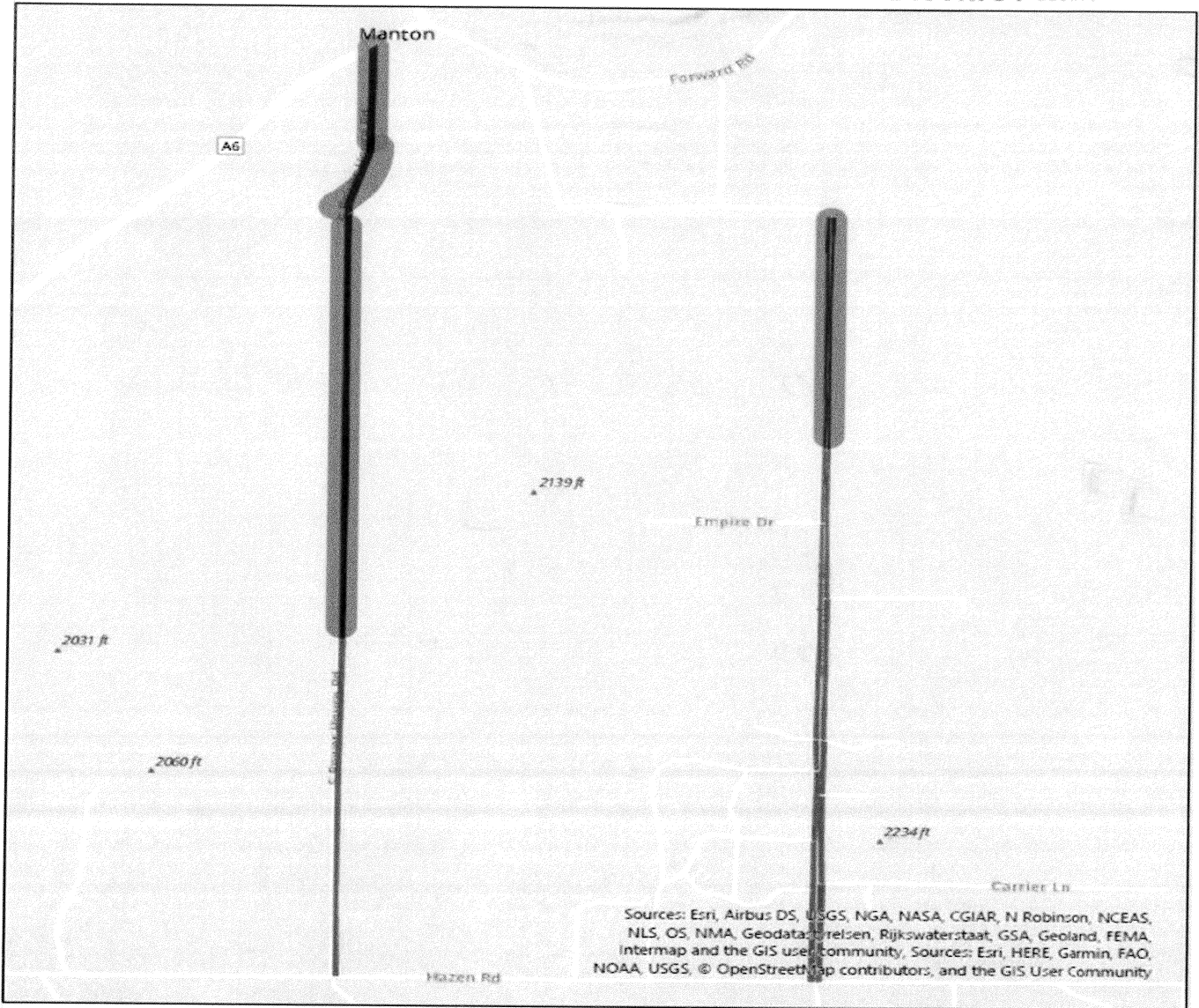

■ Manton Roadside Project Area



○ Completed 2023

Cal. Code Regs. Tit. 14, § 15304 - Minor Alterations to Land

State Regulations Compare

Class 4 consists of minor public or private alterations in the condition of land, water, and/or vegetation which do not involve removal of healthy, mature, scenic trees except for forestry and agricultural purposes. Examples include but are not limited to:

- (a) Grading on land with a slope of less than 10 percent, except that grading shall not be exempt in a waterway, in any wetland, in an officially designated (by federal, state, or local government action) scenic area, or in officially mapped areas of severe geologic hazard such as an Alquist-Priolo Earthquake Fault Zone or within an official Seismic Hazard Zone, as delineated by the State Geologist.
- (b) New gardening or landscaping, including the replacement of existing conventional landscaping with water efficient or fire resistant landscaping.
- (c) Filling of earth into previously excavated land with material compatible with the natural features of the site.
- (d) Minor alterations in land, water, and vegetation on existing officially designated wildlife management areas or fish production facilities which result in improvement of habitat for fish and wildlife resources or greater fish production.
- (e) Minor temporary use of land having negligible or no permanent effects on the environment, including carnivals, sales of Christmas trees, etc.
- (f) Minor trenching and backfilling where the surface is restored.
- (g) Maintenance dredging where the spoil is deposited in a spoil area authorized by all applicable state and federal regulatory agencies.
- (h) The creation of bicycle lanes on existing rights-of-way.
- (i) Fuel management activities within 30 feet of structures to reduce the volume of flammable vegetation, provided that the activities will not result in the taking of endangered, rare, or threatened plant or animal species or significant erosion and sedimentation of surface waters. This exemption shall apply to fuel management activities within 100 feet of a structure if the public agency having fire protection responsibility for the area has determined that 100 feet of fuel clearance is required due to extra hazardous fire conditions.